

Series 342 – Safety Lock

- Automatic safety-locking feature
- Extremely high flow capacity
- One-hand operated

Series 342 couplings withstand extremely rough handling in extra tough applications. The Series features a zinc-plated steel construction with a locking sleeve made of hardened zinc-plated steel. The Series offers a wide range of connections, as well as anti-hose whip nipples. The automatic safety-locking feature prevents unintentional disconnection.

Please refer to the CEJN Breathing Air range for an all brass version (Series 341).



TECHNICAL DATA

Nominal flow diameter	7.4 mm (9/32")
Air flow.....	1950 l/min (68.8 CFM)
Max. working pressure.....	35 bar (507 PSI)
Min. burst pressure.....	140 bar (2030 PSI)
Temperature range	-30°C – +100°C (-22°F – +212°F)
Material coupling.....	Zinc-plated steel/brass
Material nipple.....	Hardened zinc-plated steel
Connection force.....	103 N
Markets.....	Global
Standards.....	CEJN Original, 7.4 mm, Safetylock

AIR FLOW

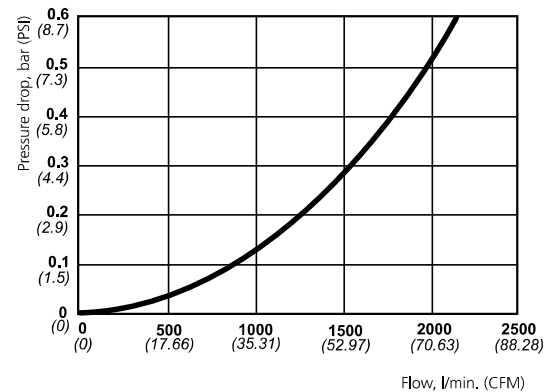

Flow capacity is measured at 6 bar (87 PSI) inlet pressure, and pressure drop at 0.5 bar (7 PSI).

	Part No.	Connection
COUPLINGS	HOSE CONNECTION	
		10 342 1002 6.3 mm (1/4")
		10 342 1003 8 mm (5/16")
		10 342 1004 10 mm (3/8")
		10 342 1005 13 mm (1/2")
	MALE THREAD	
		10 342 1152 R 1/4"
		10 342 1154 R 3/8"
		10 342 1155 R 1/2"
		10 342 1452 NPT 1/4"
		10 342 1454 NPT 3/8"
		10 342 1455 NPT 1/2"
	FEMALE THREAD	
		10 342 1202 G 1/4"
		10 342 1204 G 3/8"
	10 342 1205 G 1/2"	
	10 342 1402 NPT 1/4"	
	10 342 1404 NPT 3/8"	
	10 342 1405 NPT 1/2"	
STREAM-LINE		
	10 342 1060 6.5 x 10 mm	
	10 342 1062 8 x 12 mm	

	Part No.	Connection
NIPPLES	HOSE CONNECTION	
		10 342 5002 6.3 mm (1/4")
		10 342 5004 10 mm (3/8")
		10 342 5005 13 mm (1/2")
	MALE THREAD	
		10 342 5152 R 1/4"
		10 342 5154 R 3/8"
		10 342 5155 R 1/2"
		10 342 5452 NPT 1/4"
		10 342 5454 NPT 3/8"
		10 342 5556 M16 x 1.5
	FEMALE THREAD	
		10 342 5202 G 1/4"
		10 342 5204 G 3/8"
		10 342 5205 G 1/2"
	10 342 5402 NPT 1/4"	
	10 342 5404 NPT 3/8"	
STREAM-LINE		
	10 342 5060 6.5 x 10 mm	
	10 342 5062 8 x 12 mm	

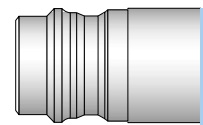

Series 442 – Safety Lock

- Automatic safety-locking feature
- Extremely high flow capacity
- One-hand operated

Series 442 couplings withstand extremely rough handling in extra tough applications. The series features a zinc-plated steel/brass construction with a locking sleeve made of hardened zinc-plated steel. The Series offers a wide range of connections, as well as anti-hose whip nipples. The automatic safety-locking feature prevents unintentional disconnection.

Please refer to the CEJN Breathing Air range for an all-brass version (Series 441).



TECHNICAL DATA

Nominal flow diameter	10.4 mm (13/32")
Air flow.....	3950 l/min (139.4 CFM)
Max. working pressure.....	35 bar (507 PSI)
Min. burst pressure.....	140 bar (2030 PSI)
Temperature range	-30°C – +100°C (-22°F – +212°F)
Material coupling.....	Zinc-plated steel/brass
Material nipple.....	Hardened zinc-plated steel
Connection force.....	169.6 N
Markets.....	Global
Standards.....	CEJN Original, 10.4 mm, Safetylock

AIR FLOW

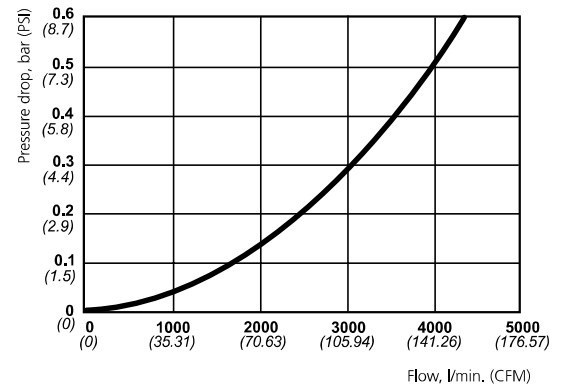

Flow capacity is measured at 6 bar (87 PSI) inlet pressure, and pressure drop at 0.5 bar (7 PSI).

		Part No.	Connection
COUPLINGS	HOSE CONNECTION	10 442 1003	8 mm (5/16")
		10 442 1004	10 mm (3/8")
		10 442 1005	13 mm (1/2")
		10 442 1006	16 mm (5/8")
		10 442 1007	19 mm (3/4")
	MALE THREAD	10 442 1154	R 3/8"
		10 442 1155	R 1/2"
		10 442 1157	R 3/4"
		10 442 1455	NPT 1/2"
		10 442 1457	NPT 3/4"
	FEMALE THREAD	10 442 1204	G 3/8"
		10 442 1205	G 1/2"
		10 442 1207	G 3/4"
		10 442 1404	NPT 3/8"
		10 442 1405	NPT 1/2"

		Part No.	Connection
NIPPLES	HOSE CONNECTION	10 442 5005	13 mm (1/2")
		10 442 5006	16 mm (5/8")
		10 442 5007	19 mm (3/4")
MALE THREAD	10 442 5152	R 1/4"	
	10 442 5154	R 3/8"	
	10 442 5155	R 1/2"	
	10 442 5157	R 3/4"	
	10 442 5454	NPT 3/8"	
	10 442 5455	NPT 1/2"	
FEMALE THREAD	10 442 5204	G 3/8"	
	10 442 5205	G 1/2"	
	10 442 5207	G 3/4"	
	10 442 5405	NPT 1/2"	

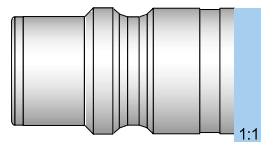

Series 550 – Vented Safety

- **Strong and durable**
- **Full automatic operation**
- **Extremely high-flow capacity**

Series 550 Vented Safety couplings feature an easy-to-grip design and require only a low connection force. They are smaller, more compact and generate higher flows than comparable designs. Series 550 couplings have an extremely low noise level upon disconnection. Anti-hose whip nipples are included in the series. The Vented Safety version disconnects in two stages in order to vent, minimize the risk of sudden component separation, reduce noise, and prevent recoil accidents. CEJN Vented Safety couplings are compliant with several international safety standards, e.g. ISO Standard 4414 and EN 983.

Series 550 Vented Safety is also available in a standard version.





TECHNICAL DATA

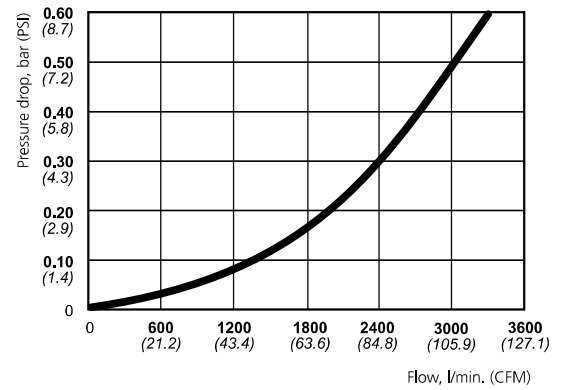

Nominal flow diameter	11 mm (7/16")
Air flow	3000 l/min (105.9 CFM)
Max. working pressure	16 bar (232 PSI)
Min. burst pressure	64 bar (928 PSI)
Connection force	68.6 N
Temperature range	20°C – +80°C (68°F – +176°F)
Material coupling	Zinc-plated steel/brass
Material nipple	Hardened zinc-plated steel
Standards	ISO 6150 B, A-A-59439, 11 mm

AIR FLOW

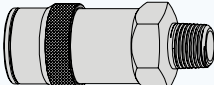

Flow capacity is measured at 6 bar (87 PSI) inlet pressure, and pressure drop at 0.5 bar (7 PSI).

		Part No.	Connection
COUPLINGS  	MALE THREAD	10 550 3155	R 1/2"
		10 550 3157	R 3/4"
		10 550 3454	NPT 3/8"
		10 550 3457	NPT 3/4"
	FEMALE THREAD	10 550 3205	G 1/2"
		10 550 3207	G 3/4"
		10 550 3404	NPT 3/8"
		10 550 3405	NPT 1/2"
	10 550 3407	NPT 3/4"	

		Part No.	Connection
NIPPLES   	HOSE CONNECTION	10 550 5004	10 mm (3/8")
		10 550 5005	13 mm (1/2")
		10 550 5007	19 mm (3/4")
	MALE THREAD	10 550 5152	R 1/4"
		10 550 5154	R 3/8"
		10 550 5155	R 1/2"
		10 550 5157	R 3/4"
		10 550 5452	NPT 1/4"
		10 550 5454	NPT 3/8"
		10 550 5455	NPT 1/2"
		10 550 5457	NPT 3/4"
	FEMALE THREAD	10 550 5204	G 3/8"
	10 550 5205	G 1/2"	
	10 550 5404	NPT 3/8"	
	10 550 5405	NPT 1/2"	
	10 550 5407	NPT 3/4"	